



V574 - V575 - V576

NEEDLE VALVE

V595 - V596

NEEDLE VALVE WITH TIP

GACHOT®



SAPAG VALVES

FRENCH INDUSTRIAL
VALVE MANUFACTURER

2 Rue du Marais
80400 Ham, FRANCE
+33 (0)3 23 81 43 00
info@sapag-valves.com
www.sapag-valves.com



<p>Performance</p>	<p>The maximum pressures and temperatures depend on the pressure / temperature ratio and type of fluid.</p> <p>Temperature, °C: -196 °C, -50 °C, 450 °C, 700 °C</p> <p>Pressure, bar: 0, 206, 250 bar</p> <p>Diameter, mm: DN8, DN25, DN250</p>
<p>Technology</p>	<p>Needle valve</p> <ul style="list-style-type: none"> V574: Butt weld (DN8 to 25) V575: Threaded gas or NPT (DN8 to 25) V576: Screwed PN16 flanges (DN10 to 25) <p>Needle valve with tip</p> <ul style="list-style-type: none"> V595: Threaded gas or NPT (DN8 to 15) V596: Screwed PN16 flanges (DN15) <ul style="list-style-type: none"> Completely made of forged and rolled low carbon stainless steel (thus pore-free). Argon welding. Removable, non-rotating needle valve, providing perfect high-pressure tightness. Embedded head gasket and wear-resistant PTFE cable gland packing. Guaranteed long-lasting tightness. Non-rotating rising stem. Thread external to fluid, yoke sleeve processed to avoid seizing. Screwed head. Cable gland protected when fully open. Excellent high-pressure resistance. Highly secure use. Unmatched corrosion resistance. Compact design.
<p>Applications</p>	<ul style="list-style-type: none"> Valve compliant with heavy duty working conditions using corrosive chemicals. Liquid, steam, gas and oil for process circuit and utilities (operating fluid). Wherever safety and reliability are critically important.
<p>Design standard</p>	<ul style="list-style-type: none"> NF EN 13709 Tightness compliant with rate A of NF EN 12266-1, ISO 5208 standards
<p>Connection</p>	<ul style="list-style-type: none"> Flanges Threaded gas or NPT BW or SW
<p>Options</p>	<ul style="list-style-type: none"> Double heating jacket. Same design as V501 gate valves. Welded finned head for high temperatures. Welded head.

Parts List

Name	Material
① Body	Stainless steel 1.4404 - EN 10272
② Needle	Stainless steel 1.4404 - EN 10272
③ Needle axis	Stainless steel 1.4404 - EN 10272
④ Stem	Stainless steel 1.4404 - EN 10272
⑤ Body seal	PTFE
⑥ Head	Stainless steel 1.4404 - EN 10272
⑦ Union nut	Stainless steel 1.4404 - EN 10272
⑧ Packing	PTFE
⑨ Gland	Stainless steel 1.4404 - EN 10272
⑩ Collar washer	Stainless steel 1.4404 - EN 10272
⑪ Gland nut	Stainless steel 1.4404 - EN 10272
⑫ Friction washer	Celoron
⑬ Cross-piece	Stainless steel 1.4404 - EN 10272
⑭ Spacing washer	Stainless steel 1.4404 - EN 10272
⑮ Handwheel	ENJM 1130 - EN 1562
⑯ Handwheel nut	Stainless steel 1.4404 - EN 10272
⑰ Connector	Stainless steel 1.4404 - EN 10272 A 37
⑱ Union nut	Stainless steel 1.4404 - EN 10272

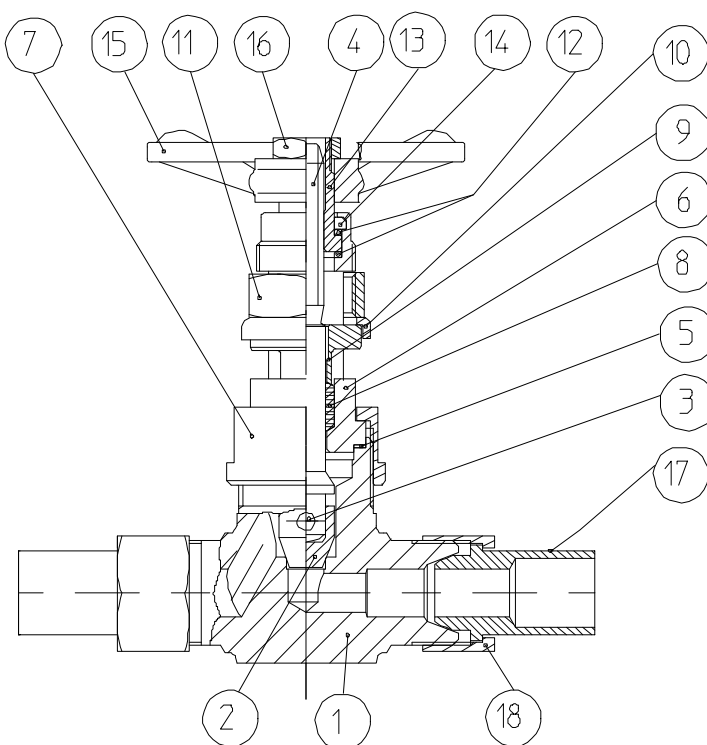

Pressure / Temperature Curves

